



-
-
- 0-5V 4-20mA
-



		(mm)	(g)	
		11	160	316L
	T_{opt}	-30-85	°C	
	T_{sto}	-40-90	°C	
	p	10	bar	
	V_{cc}	9-24	V	
	I_{out}	4-20	mA	2 (WP-UVx-G3/4-41)
				3 (WP-UVx-G3/4-42)
	V_{out}	0-5	V	3 (WP-UVx-G3/4-43)
1		220-280	nm	WP-UVC-G3/4-4y
		220-325		WP-UVB-G3/4-4y
		220-370		WP-UVA-G3/4-4y
		290-440		WP-UVV-G3/4-4y
	P	0-200	mW/cm^2	2
	5pin			
	2			

¹ UVA, UVB, UVC, UVV UV

² : 0-200 mW/cm^2 (standard), 0-1 W/cm^2 (option), 0-10 W/cm^2 (option), 0-40 W/cm^2 (option).

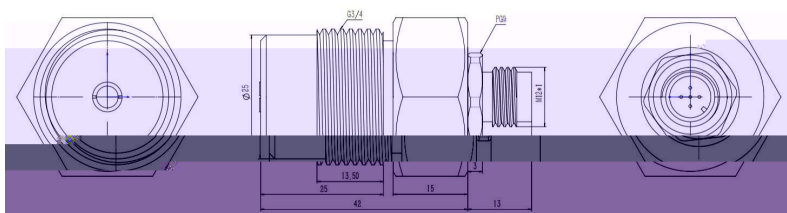
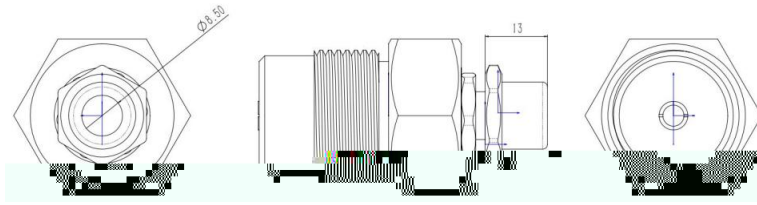

connector view
5 pin M 12x1
RSFM5

5-pin analog plug:
pin 1 = V_{cc} , pin 2 = V_{out} ,
pin 3 = I_{out} / V_{out} , pin 4 = GND / null,
pin 5 = null

5 : 1= V_{cc} , 2= , 3= , 4= / , 5=

-
-
-
-
-

100%
24 V



-
-
-
-
-

5

RS-485

9-24 V

